



Lindab Coverline™

## Lindab Fasteners

Small things that  
make a big difference



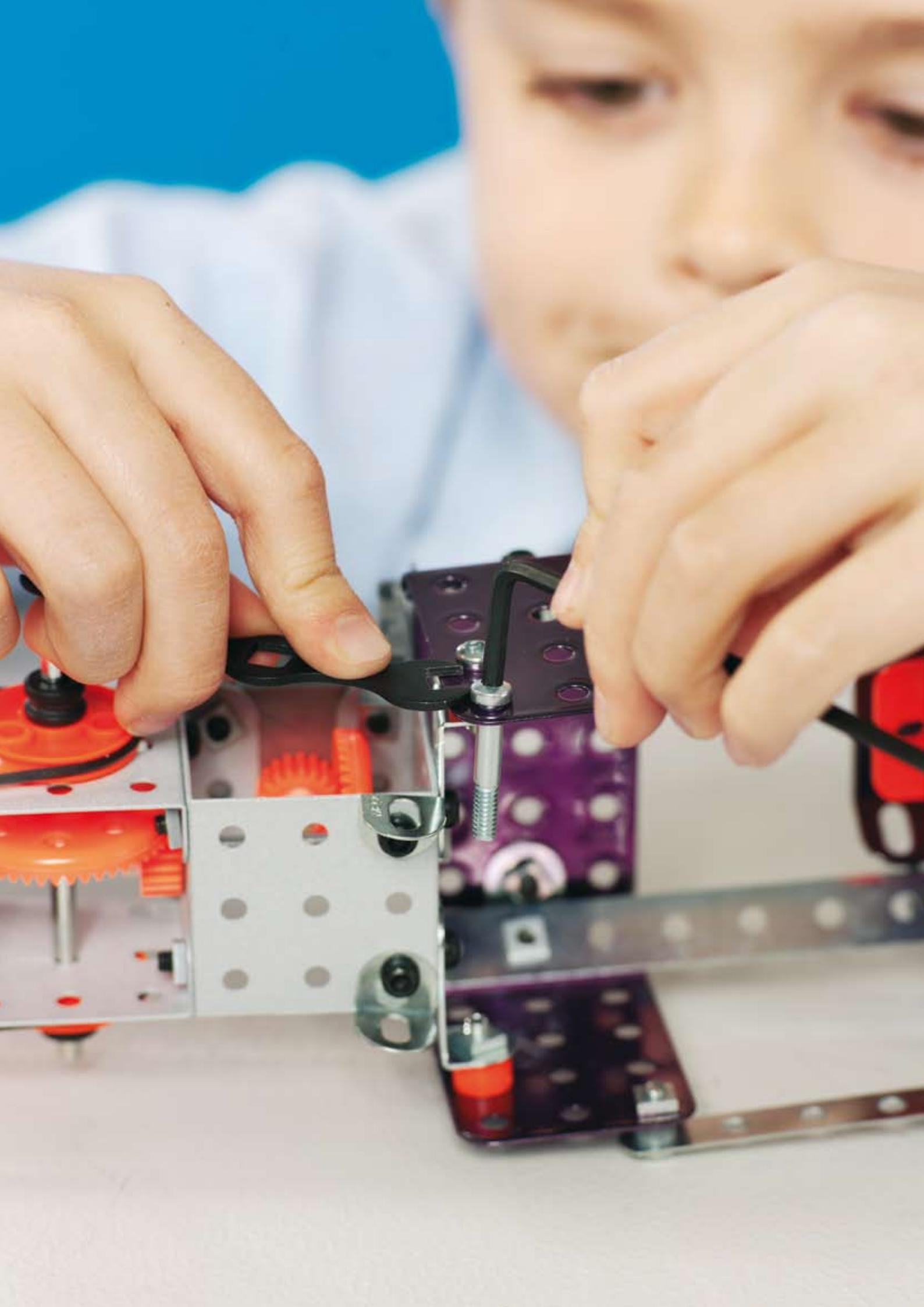

# Results that hit the mark

Steel is far superior to many other building materials. That's why it's being used more and more in all kinds of building projects. And fasteners have proved to be one of the most important components in making steel constructions successful. The right screw, nail or rivet could be crucial to the final result.

Lindab's fasteners have been specially designed to simplify the assembly of our various components and systems. They ensure not only that the effect will be pleasing to the eye, but also that it will last for years on end.

## **Lindab's fasteners in a nutshell**

- for any material combination
- rustproof
- wide range of colours
- lacquered for extreme durability





# Fasteners for any application

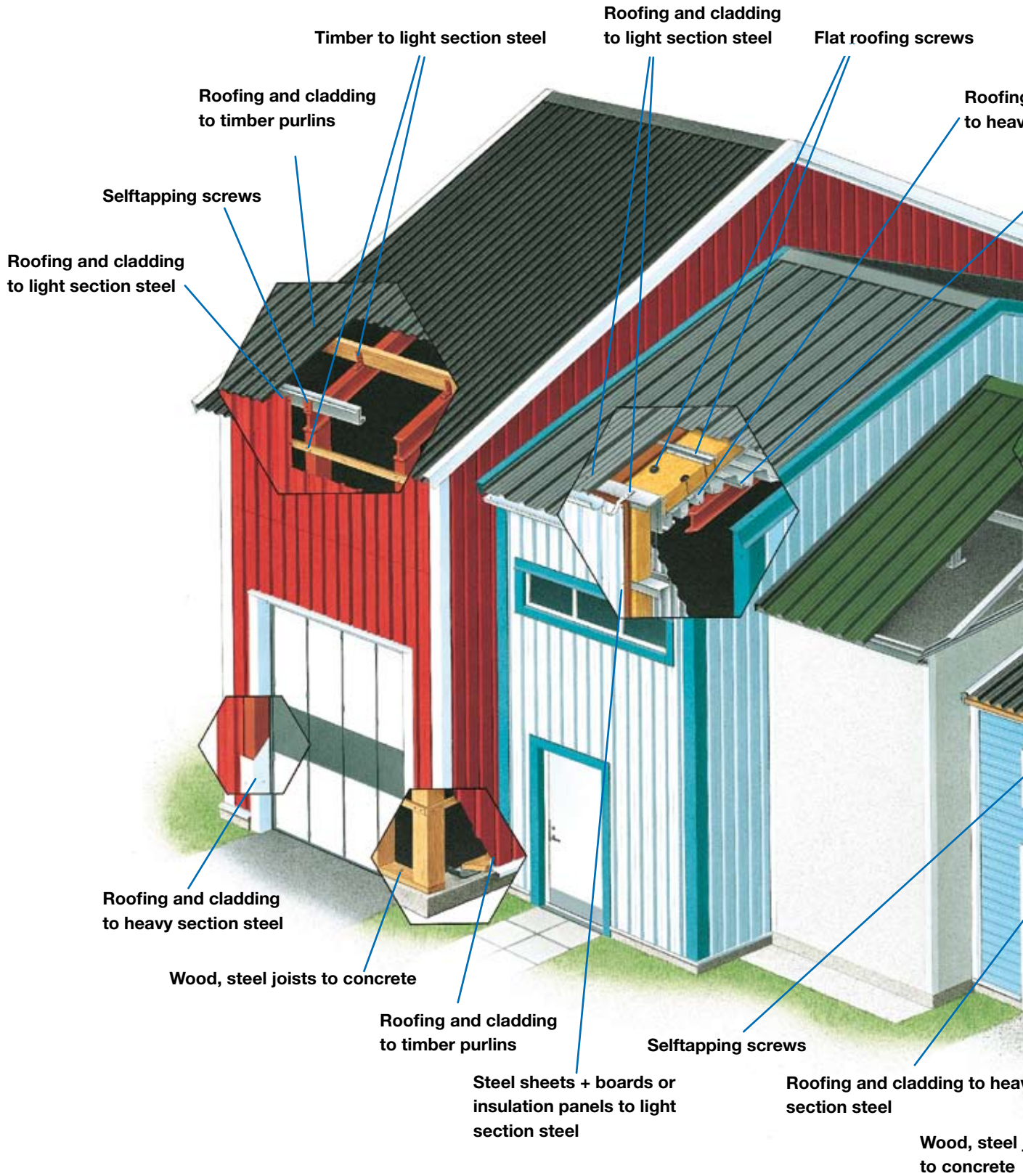

g and cladding  
y section steel

Stitching screws for  
roofing and cladding

The picture gives you a general idea of how our fasteners are used. Questions? Our sales staff, who have considerable experience of fasteners and steel constructions, will be happy to guide you.

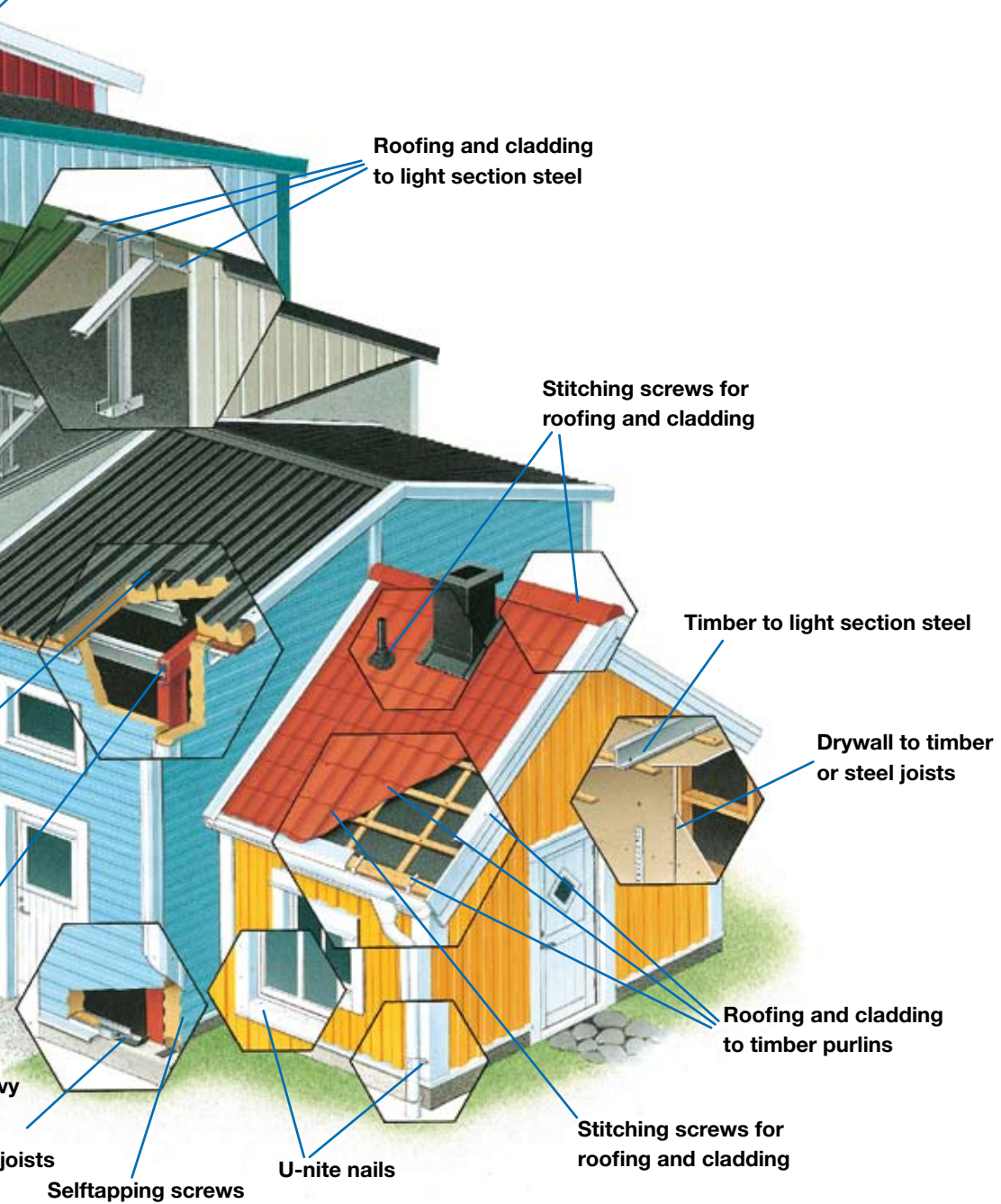

## Different solutions for different purposes



### A class of its own

Marutex® is a stainless steel drilling screw with a hardness fully comparable with hardened carbon steel. The unique drilling properties, in combination with a very high corrosion resistance, put this screw in a class of its own.

Corrosiveness class C4.



### Rustproof for durability

The life span of a fastener should always be comparable with that of the other components of your construction project. For outdoor applications, stainless steel is an indispensable choice. It'll save you money in the long run.



### A variety of colours

We stock screws for steel sheeting in around 15 standard colours, brace and tin nails in about ten and some dimensions of blind rivets in five. Most building and industrial fasteners can be ordered as a special colour option.



# A complete range of fasteners

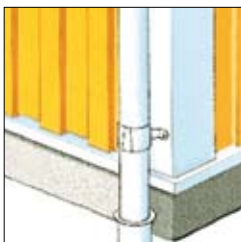
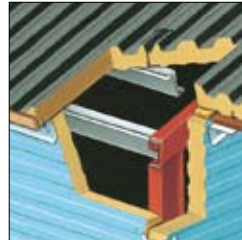
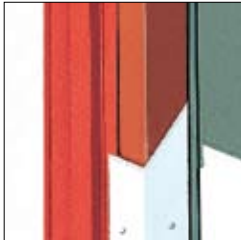
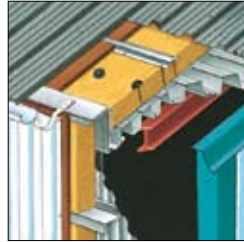

## The range includes:

- Steel sheets to wood
- Steel sheets to light steel beams
- Steel sheets to steel beams
- Steel sheets to steel sheets, overlapping
- Steel sheets, boards to light steel beams
- Sandwich panels to light steel beams
- Roof insulation to steel sheets and steel profiles
- Wood to light steel beams
- Wood and steel studs to concrete
- Nails for steel sheets to wood
- Pipe flashers
- Sockets and bits
- Blind rivets
- Industrial range

**Want to know more about Lindab Fasteners?**

[www.lindab.com/buildingtechnology](http://www.lindab.com/buildingtechnology)



Lindab Profile is a business area within the Lindab Group that develops, manufactures and markets efficient, economical and aesthetic steel and sheet-metal solutions for the building industry.

We offer everything from complete building systems to individual building components for all types of housing, as well as commercial and industrial buildings.

Lindab Profile is represented in over 25 countries throughout Europe. Our head office is in Förslöv, in the south of Sweden.



**Lindab Profile**  
SE-269 82 Båstad  
Phone +46 (0)431 850 00  
[www.lindab.com](http://www.lindab.com)